

# 5. Hemswell Cliff

LINCOLNSHIRE COUNTY COUNCIL  
PLANNING AND REGULATION COMMITTEE 7 NOVEMBER 2016

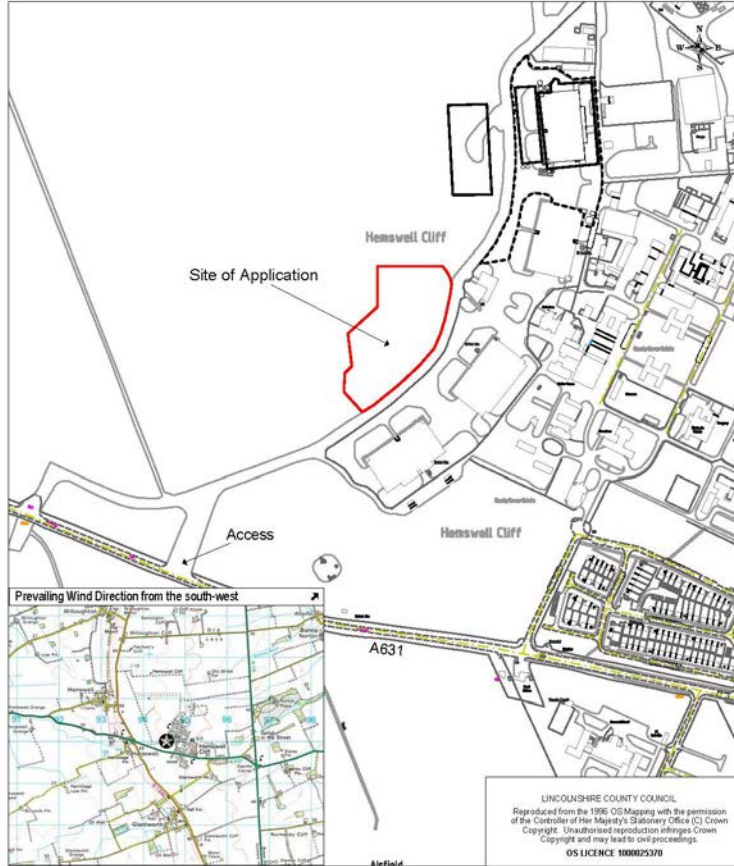

**Location:**  
Anaerobic Digestion Plant  
Hemswell Cliff

**Description:**  
To vary condition 3 of planning permission W127/133701/15 -  
To increase permitted tonnages from 40,000 tonnes per annum  
to 90,000 tonnes per annum

**Application No:** W127/134934/16  
**Scale:** 1:5000

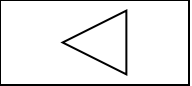

Page 36



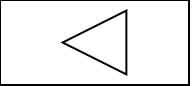

Page 37



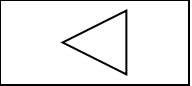

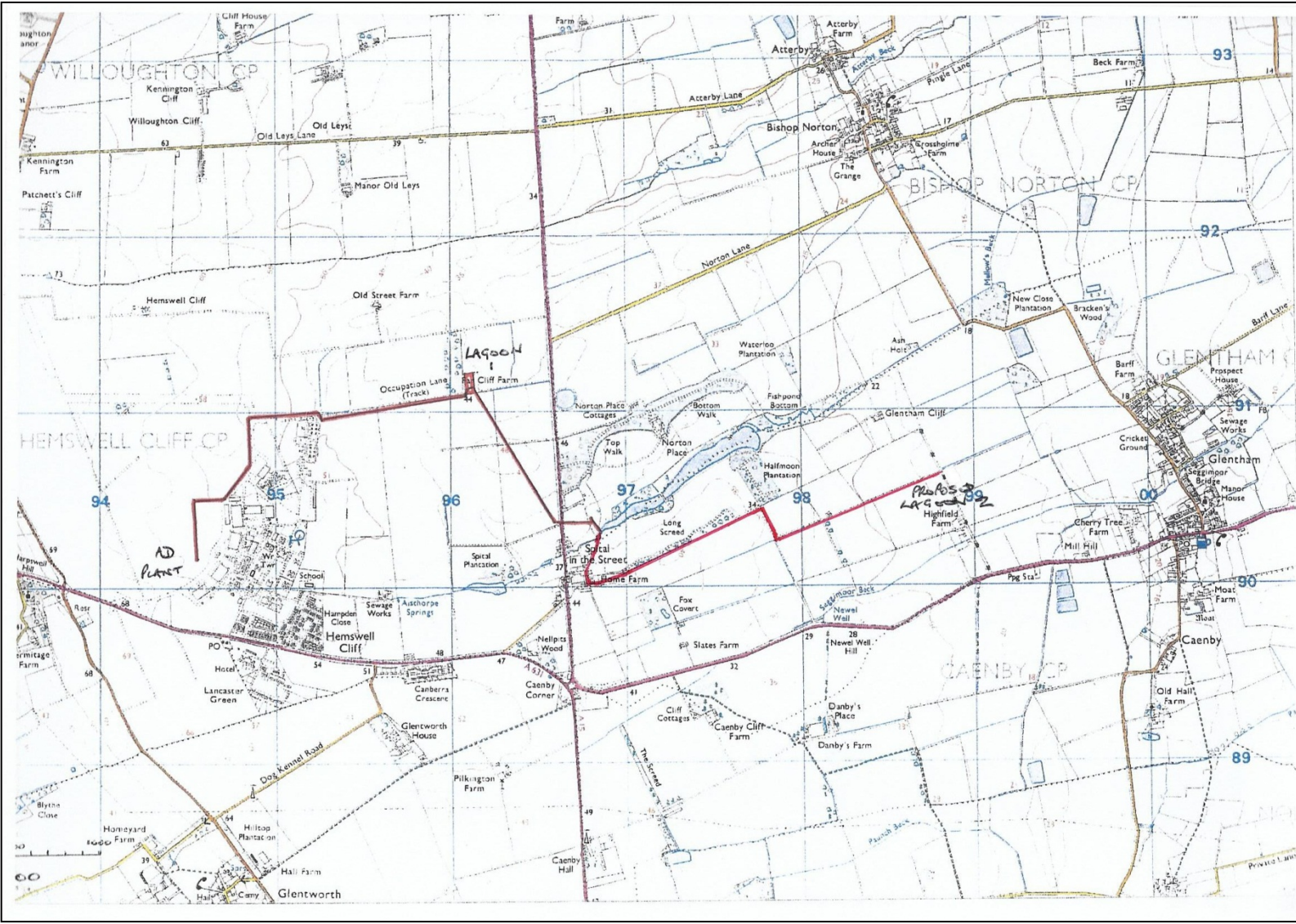

This page is intentionally left blank